

MODEL NO.	DC-080DH		
SCHEMATIC			
CENTER PIN	<table border="1"> <tr> <td>$\phi 2\text{mm}$</td> </tr> <tr> <td>$\phi 2.5\text{mm}$</td> </tr> </table>	$\phi 2\text{mm}$	$\phi 2.5\text{mm}$
$\phi 2\text{mm}$			
$\phi 2.5\text{mm}$			

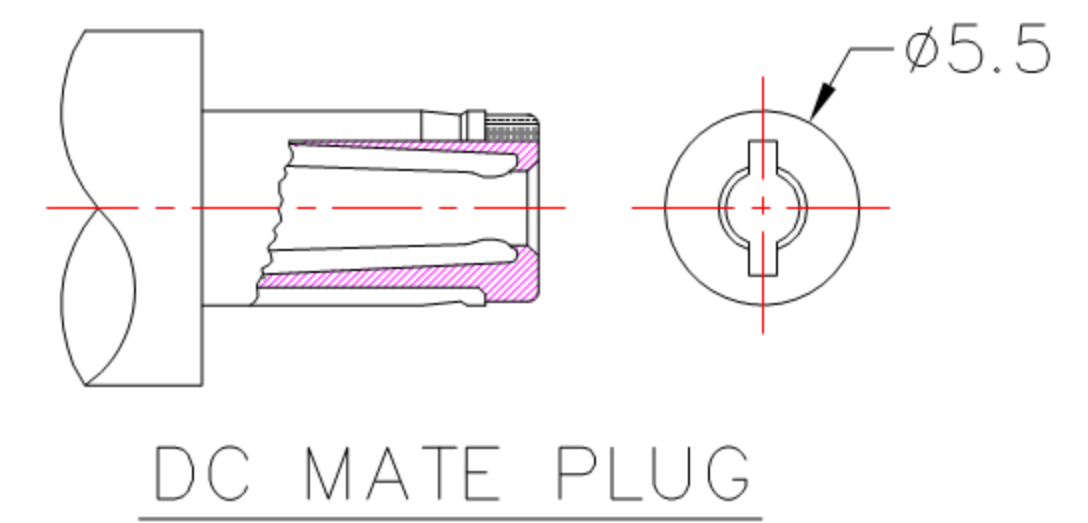

***MATERIAL**

- CENTRE PIN :PHOSPHOR BRONZE
- TERMINAL 1 :BRASS
- TERMINAL 2 :PHOSPHOR BRONZE
- TERMINAL 3 :BRASS
- HOUSING :PA6T
- COVER :PA6T

SPECIFICATION

- 1.Rating : DC 16V 5.0A
- 2.Contact resistance : $\leq 50\text{m}\Omega$
- 3.Insulation resistance : $\geq 100\text{M}\Omega$
- 4.Withstand voltage : 500VAC
- 5.Insertion and extraction force : 3-30N
- 6.life test : 5,000 cycles



TOLERANCE UNLESS OTHERWISE STATED:	Up to 5 ± 0.2	Above 5 ~ 15 ± 0.3	Above 15 ~ 30 ± 0.4	Above 30 ~ 50 ± 0.5	Angle $\pm 0.3^\circ$	3RD. ANGEL'S		UNITS	MM
------------------------------------	-------------------	------------------------	-------------------------	-------------------------	-----------------------	--------------	--	-------	----

DRAWN BY:	DATE	MAT'L	TITLE	JACK
Jack Lu	08/12/14		MODLE	DC JACK
CHECKED BY:	DATE	FINISH	DWG NO.	DC-080DH-x
Jacky Chen	08/12/14		PART NO.	DC-080DH-x
APPROVED BY:	DATE	SCALE	1 : 1	
Tony Kao	08/12/14	SHEET NO.	1 of 1	
				SIZE
				A4
				VER
				R1

1	新增SPEC	Jack	081214
ITEM NO.	DESCRIPTION	DRAWN	DATE